

HARTSVILLE/TROUSDALE COUNTY GOVERNMENT  
**ORDINANCE #199-2020-14**

**AN ORDINANCE TO AMEND ARTICLE V, SECTION 5.020 OF THE ZONING  
RESOLUTION OF TROUSDALE COUNTY, TENNESSEE, BY REZONING  
PARCEL 020.02, TAX MAP 018 FROM C-2 TO C-1**

**WHEREAS**, the land use controls of Hartsville/Trousdale County, Tennessee have been adopted for the purpose of promoting the public health, safety, morals, convenience, order, prosperity, and general welfare of the community; and

**WHEREAS**, the location and boundaries of the zoning districts established by this resolution and ordinance, are bounded and defined as shown on the official zoning map, entitled Zoning Map of Trousdale County, Tennessee, and any amendment thereto; and

**WHEREAS**, the Hartsville/Trousdale County Regional Planning Commission has duly reviewed and recommended these requests to the County Commission; and

**WHEREAS**, the County Commission has reviewed such recommendation and has conducted a public hearing prior to the second reading.

**NOW, THEREFORE, BE IT ORDAINED BY THE HARTSVILLE/TROUSDALE COUNTY COMMISSION:**

That the Zoning Map of Trousdale County, Tennessee be amended by the rezoning of a parcel from C-2 Commercial to C-1 Commercial identified as follows:

Trousdale County Tax Map 018, Parcel 020.02 this being a 5.15 acres lot located on Highway 25 West, Hartsville, TN

**BE IT ENACTED** that this ordinance shall take effect from and after its adoption, the public welfare requiring it.

*Recommended by Planning Commission June 8, 2020*

*Public Hearing to be held on July 27, 2020*

First Reading:	<u>June 22, 2020</u>	1M <u>Shane Burton</u>	2m <u>Jerry Ford</u>	Voice Vote	Absent <u>1</u>	<b>FAILED</b>
Second Reading:	<u>July 27, 2020</u>	<del>1M</del> _____	<del>2m</del> _____	Voice Vote	Absent _____	_____

**FAILED TO APPROVE ON FIRST READING – JUNE 22, 2020**

**Approved:**

**Approved:**

**Attest:**

*Dwight Jewell, Commission Chairman*

*Stephen Chambers, Mayor*

*Rita Crowder, County Clerk*

# Trousdale County - Parcel: 018 020.02

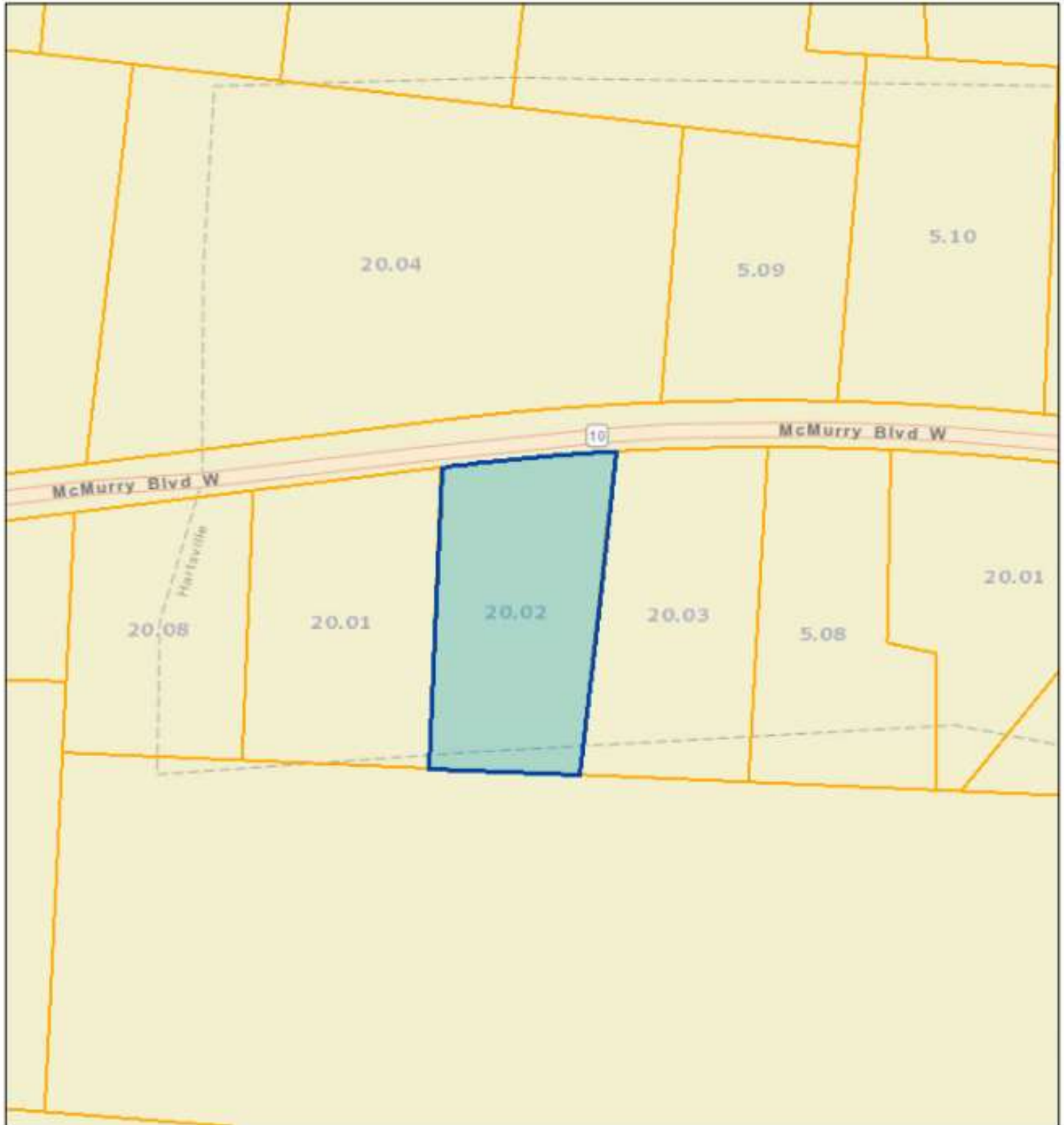

Date: June 9, 2020  
County: Trousdale  
Owner: AYOUB ZIYAD  
Address: HWY 25 W  
Parcel Number: 018 020.02  
Deeded Acreage: 5.15  
Calculated Acreage: 0  
Date of Imagery: 2017